



Broomfield Avenue, Palmers Green, London, N13
£900,000 Freehold

Anthony Webb
ESTATE AGENTS

Broomfield Avenue, Palmers Green, London, N13

Well presented four bedroom semi-detached family house offering in excess of 1900sq ft of bright and airy living space located a few minutes walk to Broomfield Park. Features include two spacious receptions, a kitchen/diner, garage to side, paved drive and good size rear garden.

Broomfield Avenue is a most popular residential turning located off Broomfield Lane and is a short walk through the park to Palmers Greens shops, restaurants, bus routes and mainline station into Moorgate.

Porch to a good size hallway • Spacious front reception with ceiling features and bay window • Rear reception with doors to garden • kitchen/diner with door to garage • First floor landing with stained glass window and access to loft space with potential to convert • Two double bedrooms • Two good size single bedrooms • Wet room • Double glazing • Gas central heating • Garage to side • Off street parking to front • Well maintained rear garden with paved patio and summer house measuring 60ft x 33ft.

- Four bedrooms
- Semi-detached house
- Two receptions
- Kitchen/diner
- Original features
- Off street parking
- Garage to side
- Rear garden





Broomfield Avenue Palmers Green London N13 4JR

Tenure: Freehold
Gross Internal Area: 1990.00 sq ft

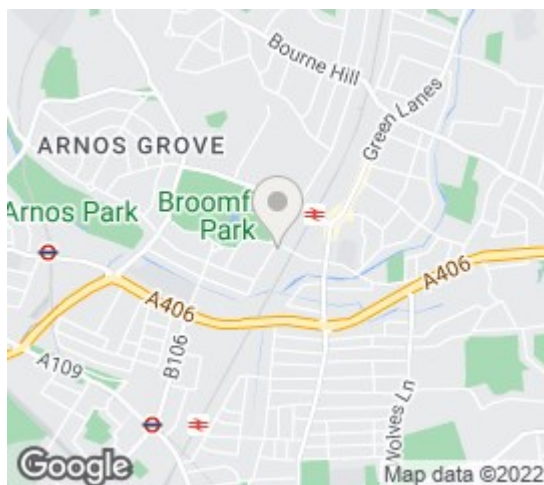

Energy Efficiency Rating		Current	Potential
Very energy efficient - lower running costs			
(92 plus) A			
(81-91) B			
(69-80) C			
(55-68) D			
(39-54) E			
(21-38) F			
(1-20) G			
Not energy efficient - higher running costs			
England & Wales		EU Directive 2002/91/EC	
Environmental Impact (CO ₂) Rating		Current	Potential
Very environmentally friendly - lower CO ₂ emissions			
(92 plus) A			
(81-91) B			
(69-80) C			
(55-68) D			
(39-54) E			
(21-38) F			
(1-20) G			
Not environmentally friendly - higher CO ₂ emissions			
England & Wales		EU Directive 2002/91/EC	

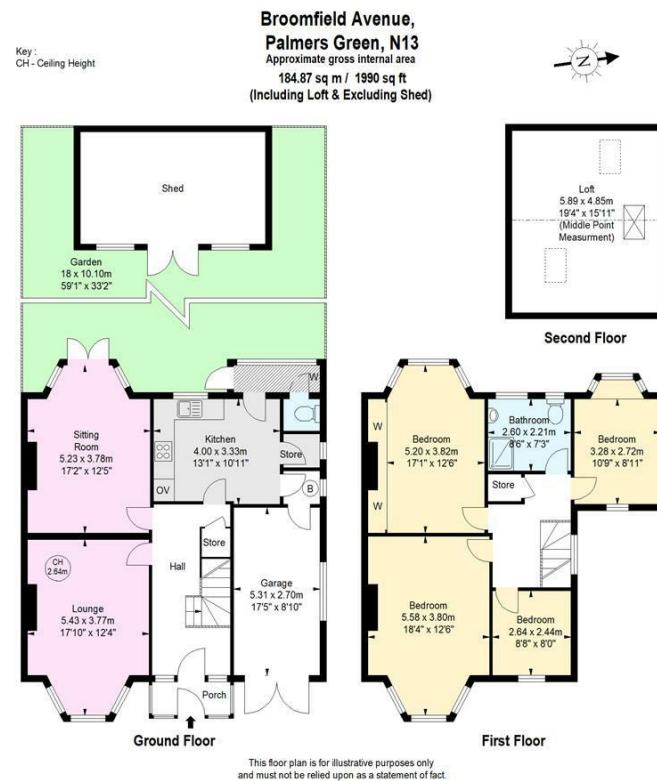

Property particulars as supplied by Anthony Webb Estate Agents are set out as a general outline in accordance with the Property Misdescriptions Act (1991) only for the guidance of intending purchasers of lessees, and do not constitute any part of an offer or contract. Details are given without any responsibility, and any intending purchasers, lessees or third parties should not rely on them as inspection or otherwise as to the correctness of each of them. We have not carried out a structural survey and the services, appliances and specific fittings have not been tested. All photographs, measurements, floor plans and distances referred to are given as a guide only and should not be relied upon for the purchase of carpets or any other fixtures statements or representations of fact, but must satisfy themselves by or of fittings, gardens, roof terraces, balconies and communal gardens as well as tenure and lease details cannot have their accuracy guaranteed for intending purchasers. Lease details, service ground rent (where applicable) are given as a guide only and should be checked and confirmed by your solicitor prior to exchange of contracts. No person in the employment of Anthony Webb has any authority to make any representation or warranty whatever in relation to this property.

348 Green Lanes, Palmers Green, London N13 5TJ
020 8882 7888
palmersgreen@anthonywebb.co.uk
anthonywebb.co.uk

Anthony Webb
ESTATE AGENTS